

PARTS LIST

ITEM	PART NUMBER	DESCRIPTION	MATERIAL
1	BASE	6 X 10 X 1/2	PLYWOOD, FINISH
2	PROMPTER-BASE	6 X 1 1/2 X 1/4	MDF MEDIUM DENSITY FIBERBOARD
3	LENS-PANEL	5 1/2 X 4 1/4 X 1/4	MDF MEDIUM DENSITY FIBERBOARD
4	HOUSING-TOP-PANEL	6 X 5 3/4 X 1/4	MDF MEDIUM DENSITY FIBERBOARD
5	BASE-SUPPORT	3 X 10 X 3/4	PLYWOOD, FINISH
6	GLASS	5 3/8 X 4 1/8 X 1/8	GLASS
7	PHONETRAY	6 X 5 5/8 X 1/4	MDF MEDIUM DENSITY FIBERBOARD
9	BASE-RAIL	3/4 X 10 X 1/2 (X2)	PLYWOOD, FINISH
11	PHONE-TRAY-STOP	2 X 3/4 X 1/2	PLYWOOD, FINISH
12	HOUSING-GUIDE	1 1/2 X 5 1/2 X 1/4 (X2)	MDF MEDIUM DENSITY FIBERBOARD
13	CAMERA-RAIL-SUPPORT	1 1/4 X 3/4 X 3/8 (X2)	PINE
14	HOUSING-SIDE-PANEL	4 1/4 X 5 3/4 X 1/4 (X2)	MDF MEDIUM DENSITY FIBERBOARD

	PROJECT			
	Teleprompter			
	TITLE			
	Teleprompter			
APPROVED	SIZE	CODE	DWG NO	REV
CHECKED	A			
DRAWN	Federico Hatoum	6/1/20	SCALE	WEIGHT
				SHEET 1/8

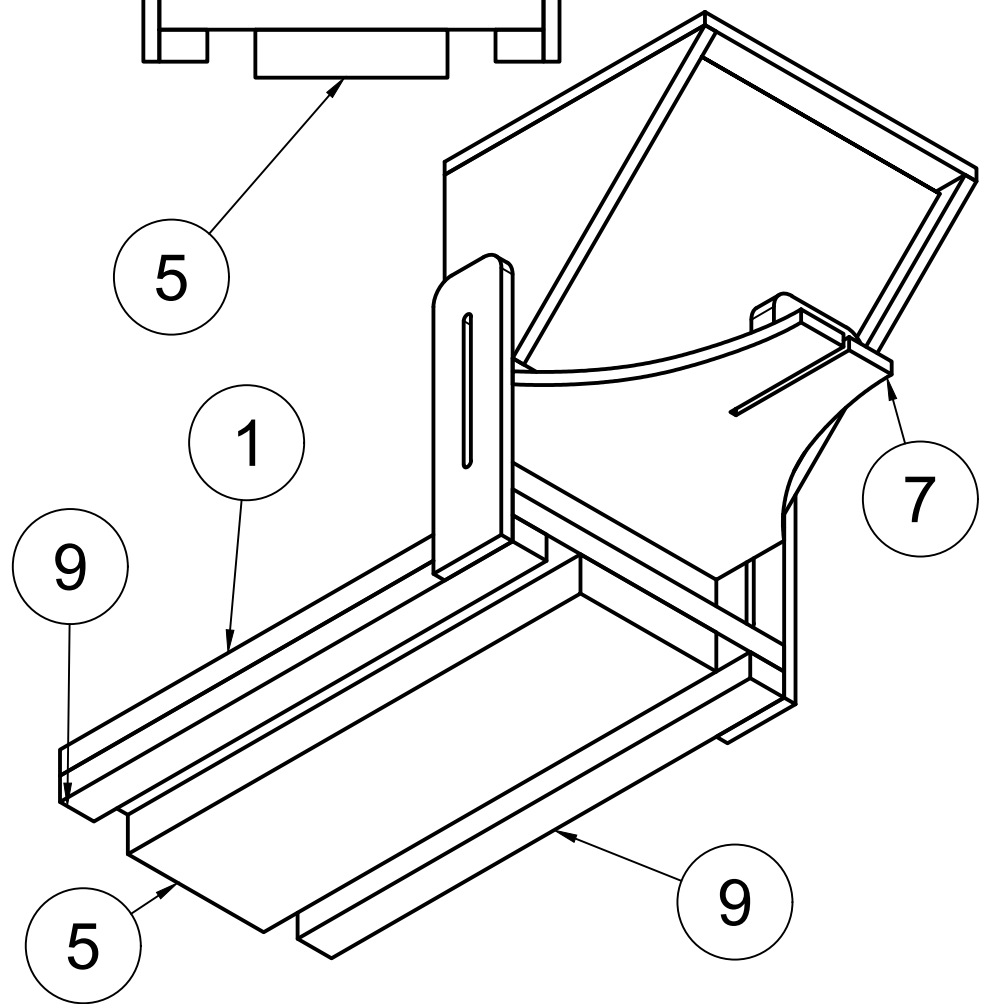

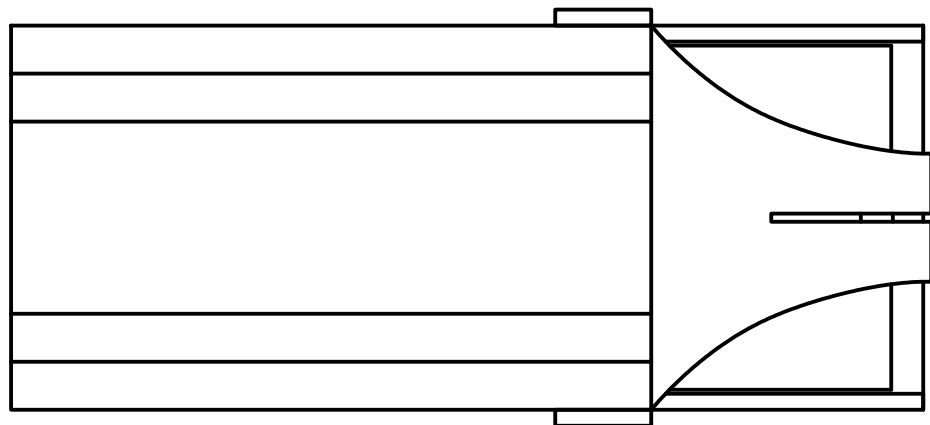
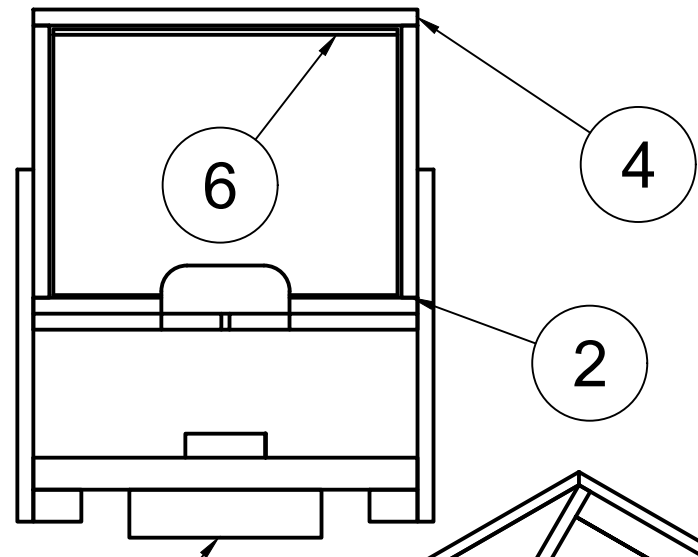
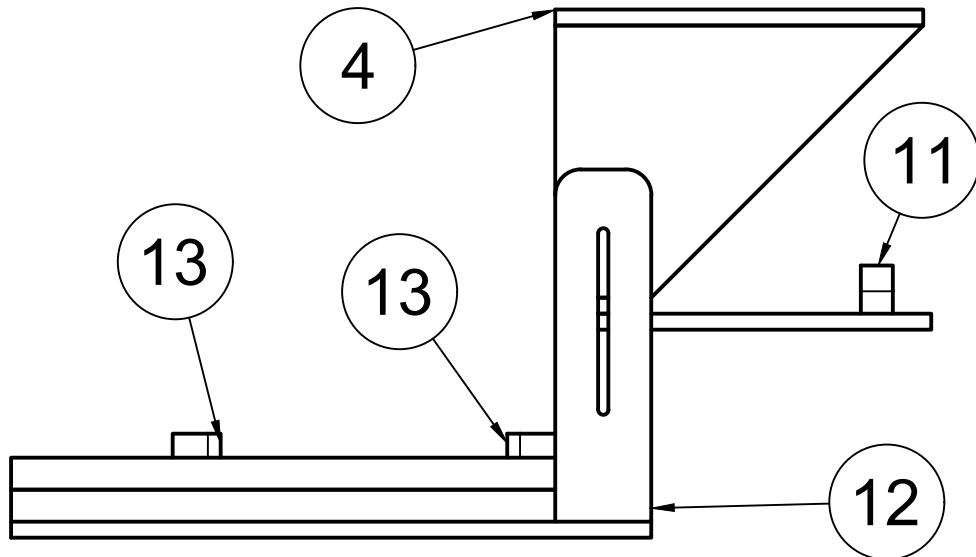
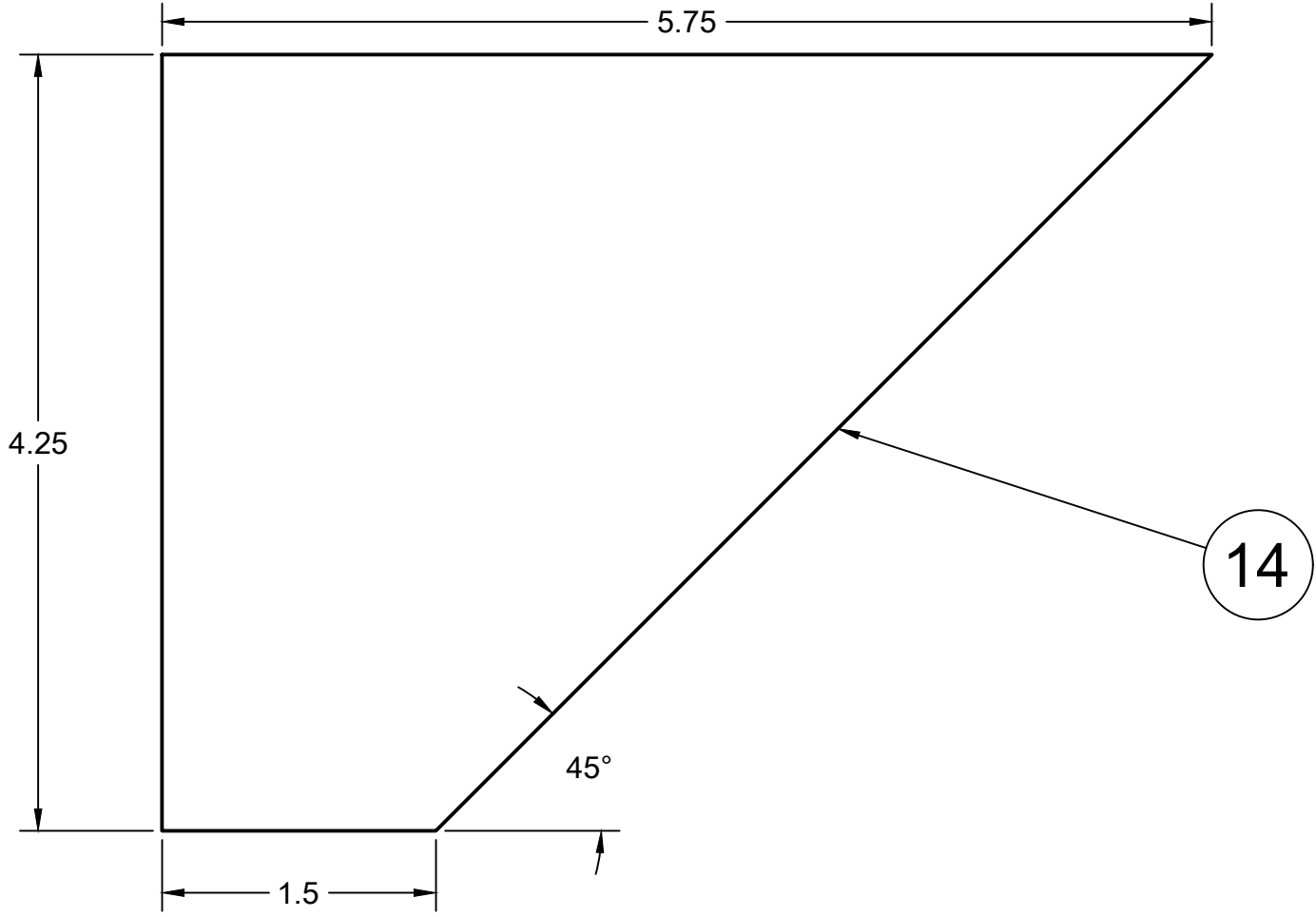

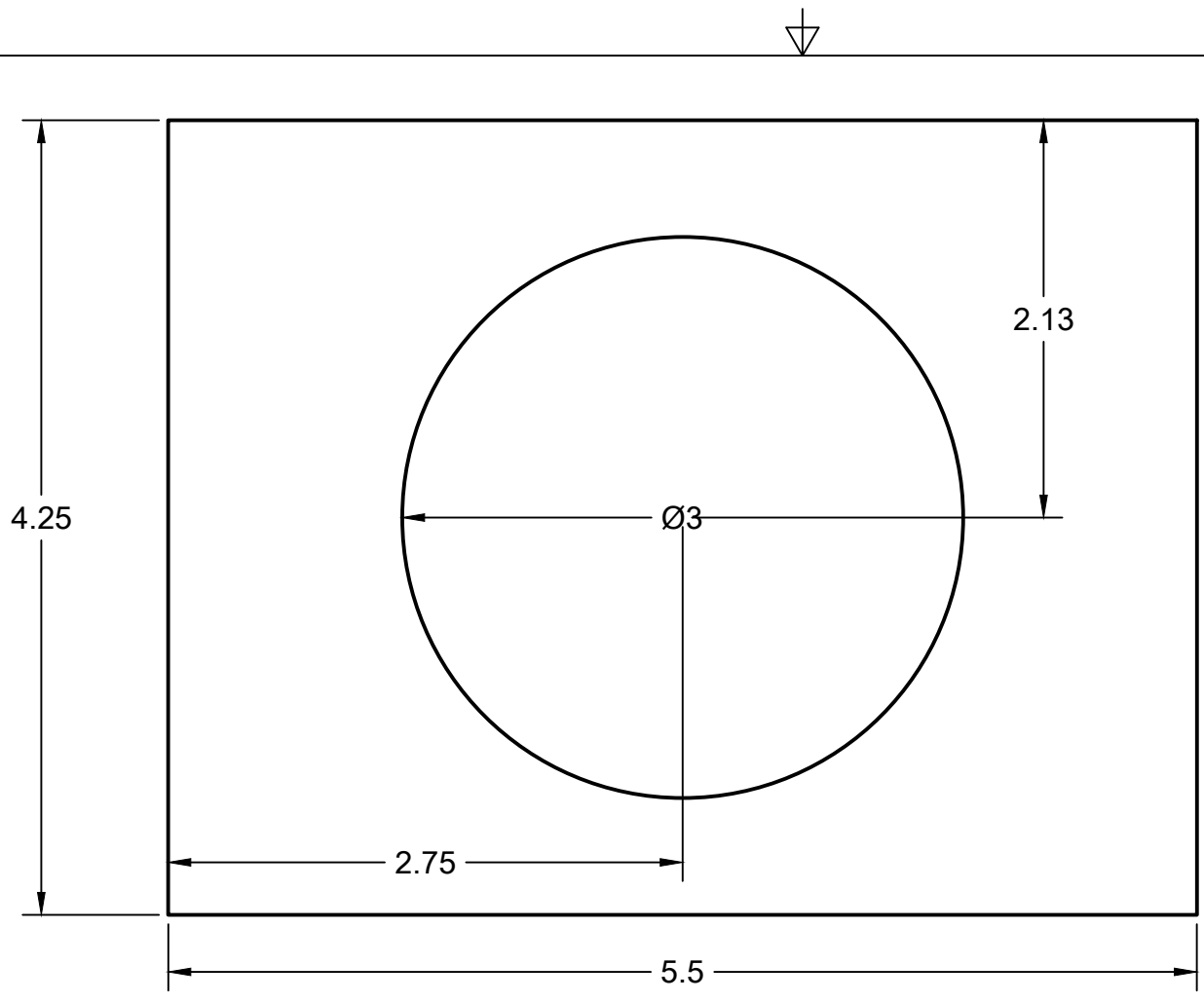

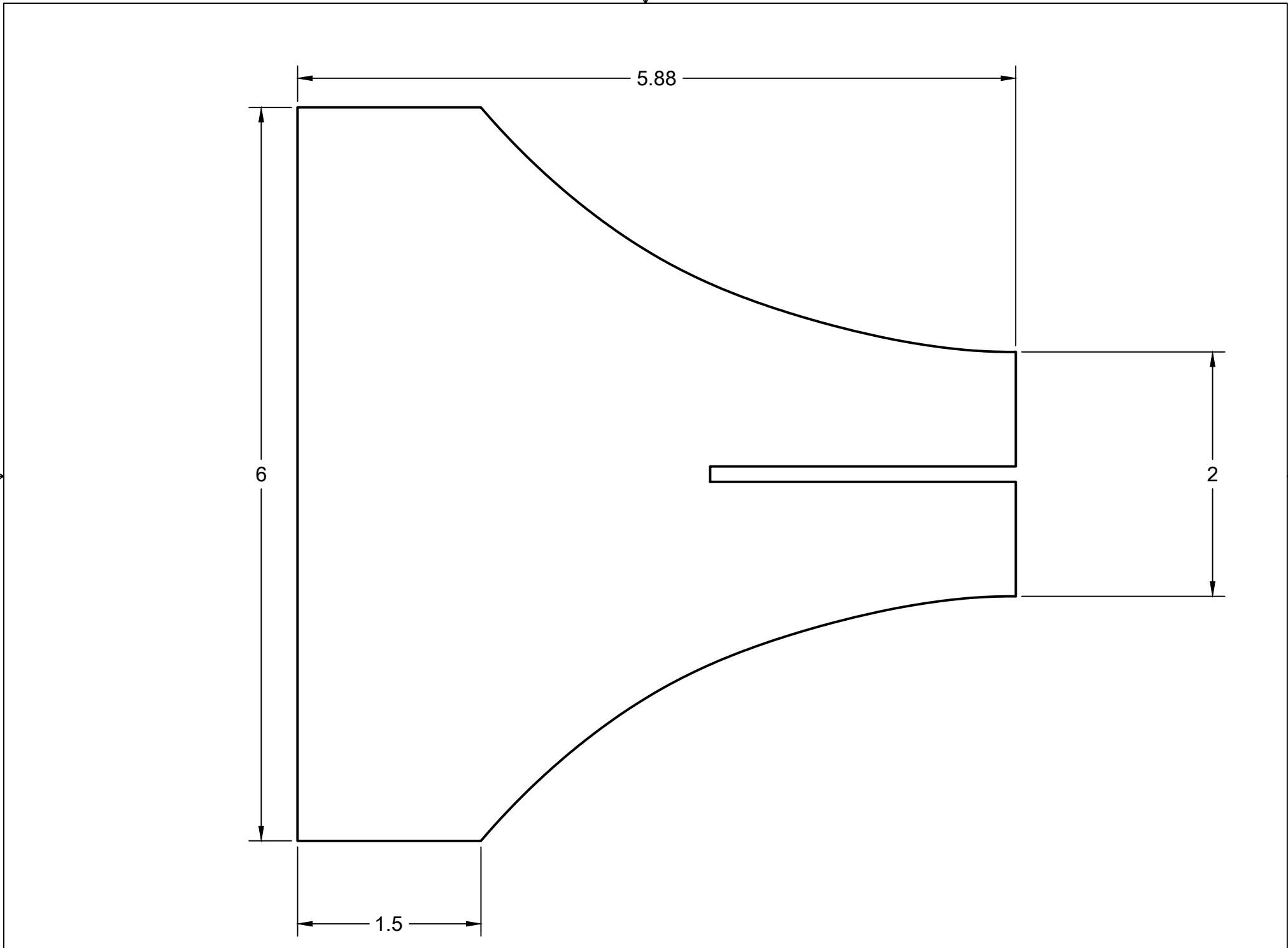

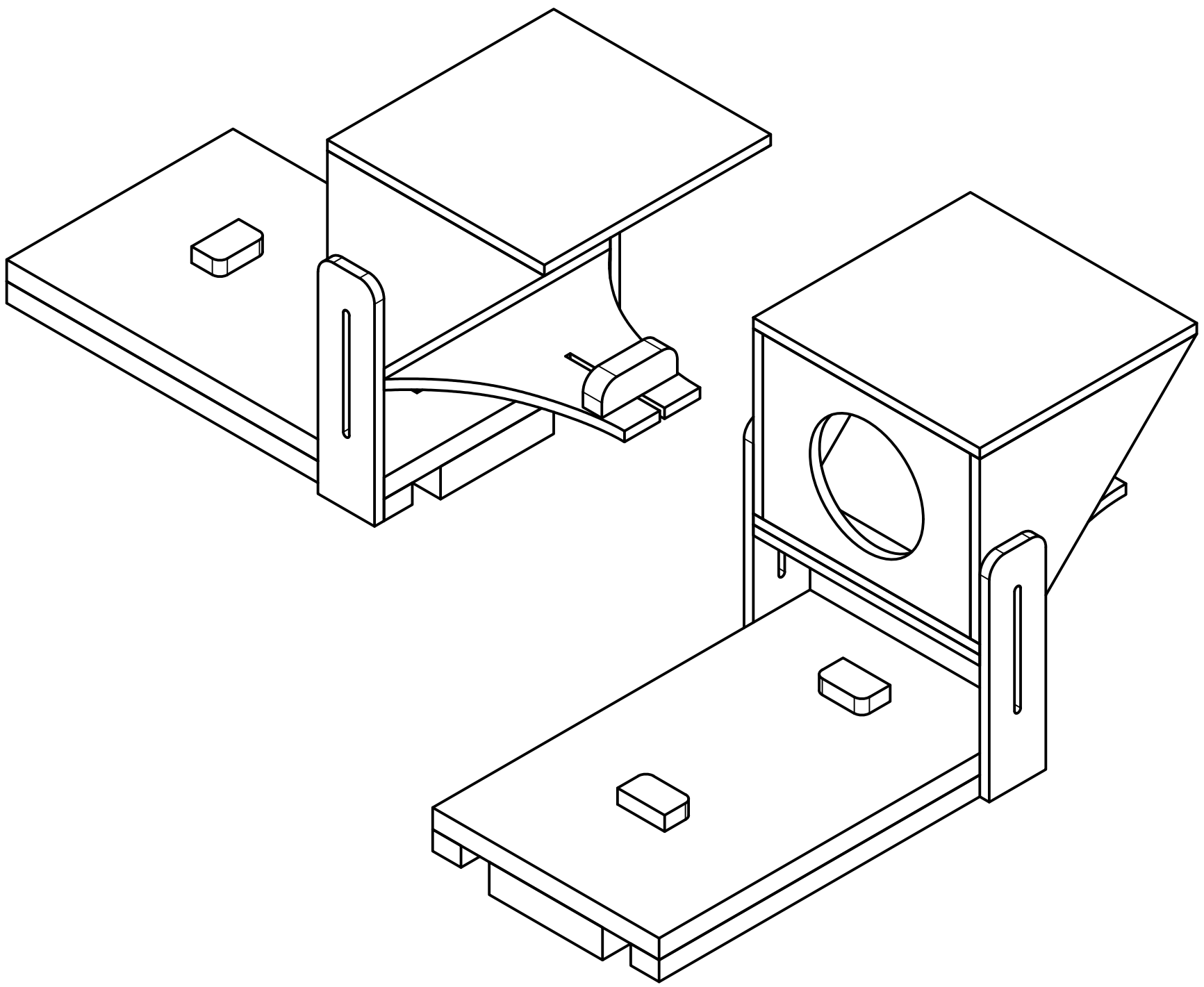

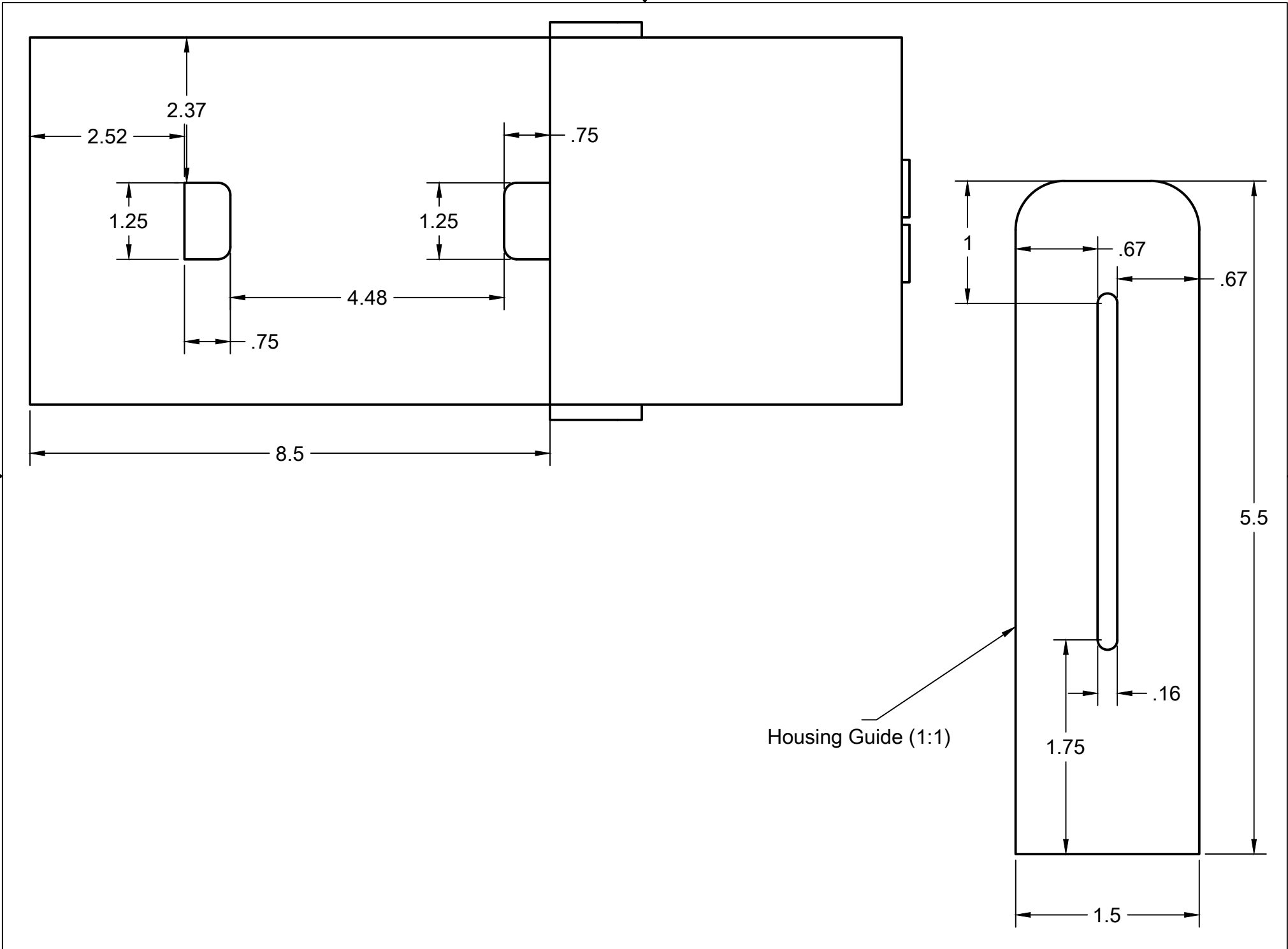

CUT ORDER:

Rips (TABLE SAW):

1. Rip long, 6" wide 1/4" MDF sheet strip.
Minimum length: 13.25"
2. Rip 6" wide 1/2" PLYWOOD strip.
Minimum length: 10"
3. Rip 3/4" wide 1/2" PLYWOOD strip.
Minimum length: 20.5" (or 2 x 10.25")
4. Rip long, 5.75" wide 1/4" MDF sheet strip.
Minimum length: 9"
5. Rip long, 5.5" wide 1/4" MDF sheet strip.
Minimum length: 7.75"
6. Rip 3" wide 3/4" PLYWOOD strip.
Minimum length:

Cross cuts (SLED):

7. From 6" MDF strip:
 - A. 1 x PROMPTER-BASE (6" X 1.5")
 - B. 1 x HOUSING-TOP-PANEL (6" X 5.75")
 - C. 1 x PHONE-TRAY (6" X 5 5/8")
8. From 6" PLYWOOD (1/2") strip:
 - A. 1 x BASE (6" x 10")
9. From 3/4" PLYWOOD (1/2") strip(s):
 - A. 2 x BASE-RAIL (3/4" x 10")
10. From 5.75" strip:
From that strip you'll make cross cuts (SLED):
 - A. 2 x HOUSING-SIDE-PANEL (5.75" x 4.25")
11. From 5.5" strip:
 - A. 2 x HOUSING-GUIDE (5.5" x 1.5")
 - B. 1 x LENS-PANEL (5.5" x 4.25")

Finishing Pieces:

1. Cut 45 degree sides on HOUSING-SIDE-PANEL pieces.
 - A. Crosscut sled with stop block and 45 degree block?
 - B. Mark and drill holes for magnet holders.
2. Glue PHONE-TRAY template on phone tray MDF piece.
 - A. Route slot for phone holder.
 - B. Cut and sand curved sides.
3. Glue HOUSING-GUIDE template on one MDF piece.
 - A. Use double-sided tape to join two MDF pieces together, with templated piece on top.
 - B. Route slot for guide nuts through both pieces.
 - C. Sand/round top corners following template.
4. Glue LENS-PANEL template on that piece.
 - A. Drill lens hole following template.
5. Cut phone stop piece.
6. Cut camera rail holder pieces.
7. Drill and place threaded inserts for camera rail.